



SERIES 500 | W. E. ANDERSON® BY DWYER

SIGHT WINDOW

Shows Level or Contents of Tanks, Pipelines; Tempered, Replaceable Glass Window



REPLACEABLE WINDOW!

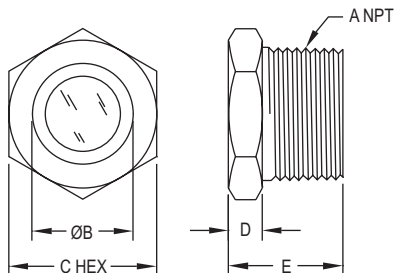

| Model | Dimensions — Inches (mm) | | | | |
|---------------|--------------------------|--------------|------------|------------|--------------|
| | A | B | C | D | E |
| SFI-500-3/4 | 3/4 | 3/4 [19] | 1-3/8 [35] | 45/64 [18] | 1-3/8 [35] |
| SFI-500-1 | 1 | 15/16 [24] | 1-3/8 [35] | 45/64 [18] | 1-3/8 [35] |
| SFI-500-1-1/4 | 1-1/4 | 1-1/4 [32] | 2-1/8 [54] | 27/32 [22] | 1-9/16 [40] |
| SFI-500-1-1/2 | 1-1/2 | 1-27/64 [37] | 2-1/8 [54] | 27/32 [22] | 1-9/16 [40] |
| SFI-500-2 | 2 | 1-1/4 [32] | 2-1/2 [64] | 15/32 [12] | 1-21/32 [42] |

The **SERIES 500** Sight Windows is a Series of standard tempered glass with brass body sight windows which display level or contents of tanks or pipelines. In addition to the standard brass body, the Series 500 Sight windows are also available in carbon steel or 316 SS.

FEATURES/BENEFITS

- Tough, tempered glass window resists chemical attack and abrasion
- Seamless, replaceable gasket assures perfect seal
- Field replaceable glass window
- Range of wetted materials to suit a wide range of chemical compatibility

APPLICATIONS

- Hydraulic tanks
- Pressure vessels
- Coolant tanks
- Hydraulic lines
- Oil reservoirs

SPECIFICATIONS

Service: Compatible gases and liquids.

Wetted Materials: Window: Tempered glass; Body: Brass, carbon steel, or 316 SS; Gasket: Buna-N on brass and carbon steel body, PTFE on 316 SS body.

Temperature Limit: 200°F (93°C).

Pressure Limit: 125 psig (8.6 bar).

Connections: 3/4" to 2" male NPT.

Agency Approvals: Meets the technical requirements of EU Directive 2011/65/EU (RoHS II).

MODEL CHART

| 316 SS Model | Brass Model | Carbon Steel Model |
|-----------------|----------------|--------------------|
| SFI-500SS-3/4 | SFI-500B-3/4 | SFI-500CS-3/4 |
| SFI-500SS-1 | SFI-500B-1 | SFI-500CS-1 |
| SFI-500SS-1-1/4 | SFI-500B-1-1/4 | SFI-500CS-1-1/4 |
| SFI-500SS-1-1/2 | SFI-500B-1-1/2 | SFI-500CS-1-1/2 |
| SFI-500SS-2 | SFI-500B-2 | SFI-500CS-2 |

USA: California Proposition 65

⚠ WARNING: Cancer and Reproductive Harm - www.P65Warnings.ca.gov